



Before operating the radio, please read all safety and operating instructions. Save all instructions in a safe place for future reference.

### WARNING: Important Safety Instructions

- Only accessories included in this package or specified by the manufacturer should be used with the radio. The 5V USB-C charging input is compatible with most high quality USB-C chargers that fully conform to the USB standards.
- Do not use cleaners or solvents to clean the exterior of the radio. Use only a damp or dry cloth.
- Do not expose this product to splashing or dripping water.
- Do not attempt to service the receiver yourself. Removing the cover will void the warranty. Changes or modifications not expressly approved by Cobra may void the user's authority granted by the governing body to operate this device and should not be made.
- Do not plug the wall adaptor into the power outlet if the outlet is wet.
- Do not use any portable radio that has a damaged antenna. If a damaged antenna comes into contact with your skin, a minor burn can result.

### WARNING: Important Safety Instructions for Battery

#### Read All Instructions

- Do not incinerate the battery even if it is severely damaged or is completely worn out.
- Do not discard battery in a fire. The battery can explode in a fire.
- Do not replace battery in any area labeled "Hazardous Atmosphere". Any sparks created in a potentially explosive atmosphere can cause an explosion or fire.
- Do not disassemble, crush, puncture, shred, or otherwise attempt to change the form of your battery.
- Do not dry a wet or damp battery with an appliance or heat source, such as a hair dryer or microwave oven.
- Do not attempt to charge alkaline batteries.
- Do not mix old and new batteries.
- Do not mix alkaline, standard (carbon-zinc), or rechargeable (Ni-Cd, Ni-MH, etc.) batteries.

Use only the supplied rechargeable batteries and charger for recharging your Cobra microTALK® radio.  
 Maximum SAR values: 0.223W/kg  
 Frequency Band: 446.00625-446.19375 MHz  
 Average and maximum radio-frequency power: 163.3mW  
 Batteries manufactured by:  
 SHENZHEN FBTECH CO.,LTD, Part No. AAAJ300 /  
 Huizhou Shenzhen Super Power Technology Co.,Ltd, Part No. AAA300



### Introduction

#### Making Life Easier and Safer

Staying in touch with your family and friends is convenient and easy when using your microTALK® radio. Some of the many uses you will discover include:

Communicating with others while hiking, biking, and working; keeping track of family and friends at a crowded public event; checking with travel companions in another car; talking with neighbors; arranging meeting spots with others while shopping at the mall.

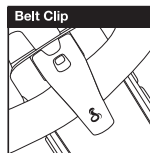

#### Secure your microTALK® radio while on the go.

Carrying your microTALK® radio with you is easy when using the belt clip or optional wrist strap.

The belt clip easily attaches to your belt, purse, or backpack.



### Customer Assistance

#### Product Service & Support

#### For Warranty, Product Service and Accessory Information

Should you encounter any problems with this product, or not understand its many features, please refer to this owner's manual. If you require further assistance after reading this manual, please contact your local dealer or distributor or go to <https://eu.cobra.com/pages/contact-us>.

©2024 Cobra Electronics Corporation  
[www.eu.cobra.com](http://www.eu.cobra.com)



### Customer Assistance

#### Operational Cautions

Exposure to high volume sound levels may cause temporary or permanent damage to your hearing. Although there is no single volume setting that is appropriate for everyone, you should always use your radio with the volume set at low level and avoid prolonged exposure to high volume sound levels.

- Set the volume control in a low position and use as low a volume as possible.
- Avoid turning up the volume to block out noisy surroundings. Whenever possible, use your radio in a quiet environment with low background noise.
- Limit the amount of time you use headsets or earpiece at high volume levels.
- When using the radio without a headset or earpiece, do not place the radio's speaker directly against your ear.
- Observe all signs and instructions that require an electrical device or RF radio product to be switched off in designated areas, such as gas/refueling stations, hospitals, blasting areas, potentially explosive atmospheres, or aircraft.
- If you experience a skin irritation after using this product, discontinue use and seek medical attention.
- If the product or charger: overheats; has a damaged cord or plug; has been dropped or damaged; has been dropped into water, disconnect any charger from its power supply, discontinue use of the product.

#### Electromagnetic Interference

Nearly every electronic device is susceptible to electromagnetic interference (EM) if inadequately shielded, designed, or otherwise configured for electromagnetic compatibility. Turn off your radio in any facility where posted notices instruct you to do so. These facilities may include hospitals or health care facilities that may be using equipment that is sensitive to external RF energy.

- When instructed to do so, turn off your radios when on board an aircraft. Any use of a RF device must be in accordance with applicable laws, regulations and airline crew instructions.
- Some radios may interfere with some hearing aids. In the event of such interference, you may want to consult your hearing aid manufacturer or physician to discuss alternatives.
- If you use any other personal medical device, consult the manufacturer of your device to determine if it is adequately shielded from RF energy. Your doctor or physician may be able to assist you in obtaining this information.



### Introduction

#### Product Features

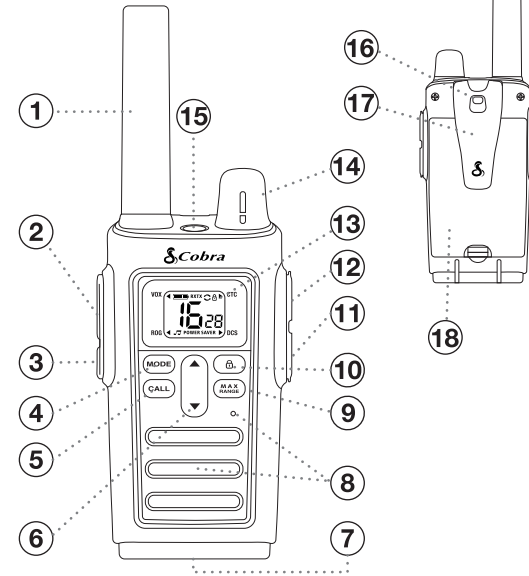

- |                         |                                      |
|-------------------------|--------------------------------------|
| 1. Antenna              | 11. USB Charge Jack                  |
| 2. Push-to-Talk Button  | 12. External Speaker/Microphone Jack |
| 3. Flashlight Button    | 13. Backlit LCD Display              |
| 4. Mode Button          | 14. ON/OFF/Volume Knob               |
| 5. Call Button          | 15. Emergency Alert Button           |
| 6. Up/Down Button       | 16. Wrist Strap Connection           |
| 7. LED/S.O.S Flashlight | 17. Belt Clip                        |
| 8. Speaker/Microphone   | 18. Battery Compartment Door         |
| 9. Maximum Range Button |                                      |
| 10. Lock Button         |                                      |



### Operation

#### Mode Functions

#### Scrolling Through the Mode Function

By scrolling through the Mode function, you will be able to select or turn on preferred features of your microTALK® radio. When scrolling through the Mode function, your radio features will be displayed in the same predetermined order:

- Channel Selection
- Set CTCSS Privacy Codes
- Set DCS Privacy Codes
- Set Vox On/Off
- Set Vox Sensitivity
- Set Channel Scan
- Set Call Tones 1-10
- Set Roger Beep On/Off
- Set Key Tones On/Off

#### Channel Selection

The radio has 16 channels, all channels are compatible with other brands of Two-Way radios.

- Briefly press and release Mode button, the channel number flashes.
- Press Up or Down button to select a channel. (You can hold the Up or Down button for fast advance)
- When the desired channel is displayed, choose one of the following:
  - Press the Mode button to enter the new setting and proceed to other functions.
  - Press the Talk or Call button to save the new setting and return to Standby mode.
  - Do not press any buttons for 6 seconds to save the new setting and return to Standby mode.

Both radios must be tuned to the same channel/privacy code to communicate.

See page 17 for frequency allocations charts.

#### Backlit LCD Display

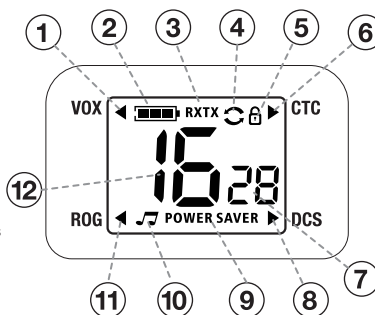

#### Features

- 16 Channels
- 121 Privacy Codes (38 CTCSS codes/ 83 DCS codes)
- Hands-Free Operation (VOX)
- Scan Channels, privacy codes
- Backlit LCD Display
- LED/S.O.S Flashlight
- Call Alert Ten selectable tones
- Button Lock
- Speaker/Microphone
- Charge Jack
- Roger Beep Selectable On/Off
- Battery/Power Saver
- Keystroke Tones Selectable On/Off
- Battery Level Indicator
- Low Battery Audible Alert
- Auto Squelch
- Maximum Range Extender
- Belt Clip
- Emergency Call

- VOX Indicator
- Battery Level Indicator
- Receive/Transmit Indicator
- Rewind-Say-Again® Icon
- Lock Icon
- CTCSS Indicator
- DCS/CTCSS Privacy Code Numbers
- DCS Indicator
- Power Saver Icon
- Key Tone Icon
- Roger Beep Indicator
- Channel Numbers

Maximum range may vary and is based on unobstructed line-of-sight communication under ideal conditions.

#### Caring for Your microTALK® Radio

Your microTALK® radio will give you years of trouble-free service if cared for properly. Handle the radio gently. Keep the radio away from dust. Never put the radio in water or in a damp place. Avoid exposure to extreme temperatures.

#### Installing Batteries



#### To install or replace batteries:

- Remove belt clip by releasing belt clip latch and sliding clip up.
- Pull up on the battery door latch to remove the battery compartment cover.
- Insert the supplied three AA rechargeable batteries or non-rechargeable alkaline batteries. Position batteries according to polarity markings.
- Replace battery compartment cover and belt clip.

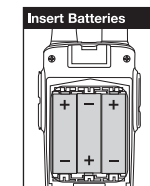

Maximum range may vary and is based on unobstructed line-of-sight communication under ideal conditions.

Maximum range may vary and is based on unobstructed line-of-sight communication under ideal conditions.



### Operation

#### Using Your Radio

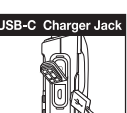

#### To charge batteries in radio:

- Check to see that the batteries have been inserted properly.
- Insert the cable into the charge jack located at the right side of the radio.
- Plug the cable into USB-compatible power port.
- The radio will display flashing battery icon while charging.

Only use the supplied rechargeable batteries and desktop charger (not included) for recharging your Cobra microTALK® radio.

Please charge new batteries for 14 hours for first time of use.

Note: Cobra recommends your radio is turned off while being charged.

#### Quick Start

- Turn ON/OFF/Volume Knob clockwise to turn the radio on and counter clockwise to turn the radio off.
- Select a desired channel. (Details please refer P.8)

Both radios must be tuned to the same channel/privacy code to communicate.

- Press and hold the Talk button while speaking into the microphone.
- When finished talking, release the Talk button and listen for a response.

#### Turning your Radio On and Off

Turn ON/OFF Knob clockwise to turn the radio on and counterclockwise to turn the radio off.



- In the ON position, the radio chirps and briefly shows all feature icons available on the radio.
- The display screen then shows the current channel, code and all features that are enabled.

#### Battery Low

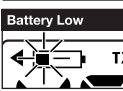

When battery power is low, the final bar in the Battery Low icon will blink and an audible tone will sound twice before the radio shuts off. Your batteries should be recharged. It normally takes about 14 hours to fully charge batteries.

The radio will display flashing battery icon while charging if the radio is on.

#### Auto Battery Save

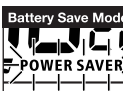

If there are no transmissions within 10 seconds, the radio will automatically switch to Battery Save mode and the Power Saver icon will flash in the display. This will not affect the radio's ability to receive incoming transmissions.

#### Communicating with Another Person



- Press and hold the Talk button.
- With the microphone about two inches (5 cm) from your mouth, speak in a normal voice.
- Release the Talk button when you are finished talking and listen for a response. You cannot receive incoming calls while pressing the Talk button.



Both radios must be tuned to the same channel/privacy code to communicate.

#### Listening for a Response



Release the Talk button to receive incoming transmissions. Your microTALK® radio is normally in Standby mode while the Talk, or Call buttons are not pressed.

#### To Adjust Volume



Press and hold the MAX-RANGE button for three seconds to turn off the auto squelch. Adjust the Volume knob until you reach a comfortable listening level.

- Rotate Volume Knob clockwise to increase the volume.
- Rotate Volume Knob counterclockwise to decrease the volume.
- Press and hold the MAX-RANGE button again to re-enable the auto squelch.

Do not hold the radio close to your ear. If the volume is set to an high level, it could hurt your ear.

#### Call Button

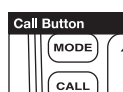

Press and release the Call button to alert others that you are calling.

The other person will hear a two second call tone which is also heard on the radio that is transmitting. This tone is used only to establish voice communications.

See page 14 on how to select between ten call tone settings.

#### LED/S.O.S. Flashlight

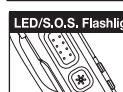

Press and release the LED/S.O.S Flashlight button below the Talk button to use the LED flashlight located at the bottom of the radio.

To activate S.O.S. function, press and hold the LED/S.O.S Flashlight button to turn on. Press and release to turn off the flashlight or S.O.S. function.

#### Auto Squelch/Maximum Range

Your microTALK® radio will automatically mute weak transmissions and unwanted noise due to terrain, conditions or if you've reached your Maximum Range limit.

You can turn off auto squelch (or turn on maximum range extender), allowing all signals to be received and extending the maximum range of your radio.

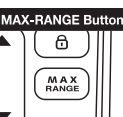

To turn maximum range extender on (Turn off auto squelch):

– Press and hold the MAX-RANGE button for at least three seconds until you hear background noise which indicates the maximum range extender is on.

To turn maximum range extender off (Turn on auto squelch):

– Press and hold the MAX-RANGE button.

#### Lock Function

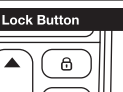

The Lock function locks the Up, Down, Mode, Max Range and call buttons to prevent accidental operation.

#### To turn the lock on or off:

– Press and hold the Lock button for two seconds.



A beep sound is used to confirm your lock on or off request. When in Lock mode, the Lock icon will be displayed.

#### microTALK® Range



Your range will vary depending on terrain and conditions. Maximum range is achieved with line of site, hilltop to hilltop.



Buildings and foliage in the path of the signal can reduce the range of the radio.



Dense foliage and hilly terrain will further reduce the range of the radio.

Remember, you can achieve maximum range by using maximum range extender. See page 6 for details.

## Operation

### Mode Functions (continued)

#### Voice Activated Transmit (VOX)

In **VOX** mode, your microTALK® radio can be used “hands-free,” automatically transmitting when you speak. You can set the **VOX** sensitivity level to fit the volume of your voice and avoid transmissions triggered by background noise.

- To turn VOX mode on or off:**
- Press the **Mode** button repeatedly until the **VOX** indicator flashes and the current sensitivity level is displayed.
  - Press the **Up** or **Down** button to turn **VOX On** or **Off**.
  - Choose one of the following:
    - Press the **Mode** button to enter the new setting and proceed to other functions.
    - Press the **Talk** or **Call** button to save the new setting and return to **Standby** mode.
    - Do not press any buttons for 6 seconds to save the new setting and return to **Standby** mode.

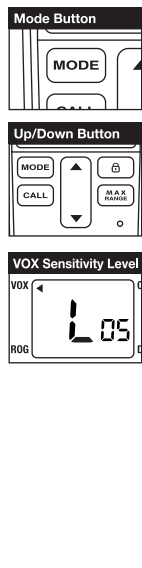

- To set VOX sensitivity:**
- Press the **Mode** button repeatedly until the **VOX** indicator flashes and the current sensitivity level is displayed.
- The current VOX sensitivity level is displayed with letters “L” and a Number 1 through 5, with Number 5 being the most sensitive level and Number 1 being the least sensitive level.

- Press the **Up** or **Down** button to change the setting.
- Choose one of the following:
  - Press the **Mode** button to enter the new setting and proceed to other functions.
  - Press the **Talk** or **Call** button to save the new setting and return to **Standby** mode.
  - Do not press any buttons for 6 seconds to save the new setting and return to **Standby** mode.

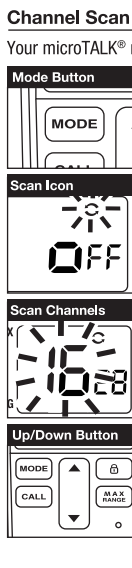

- Channel Scan**
- Your microTALK® radio can automatically scan channels.
- To scan channels:**
- Press the **Mode** button repeatedly until the **Scan** icon and the current **off** setting are flashing.
  - Press the **Up** or **Down** button to select **Channel Scan on** or **off**.
  - Choose one of the following:
    - While the current setting is **on**, press **Talk** or **Call** button to begin scanning channels.
    - While the current setting is **on**, do not press any button for 6 seconds to begin scanning channels.
    - While the current setting is **off**, press **Mode** button to proceed to other functions.
    - While the current setting is **off**, press **Talk** or **Call** button to return to **Standby** mode.
    - While the current setting is **off**, do not press any buttons for 6 seconds to return to **Standby** mode.
- The radio will check privacy codes while scanning channels.

The **Scan** icon will continue to be displayed when scan is **on**. Your radio will continue to scan all channels and stop if an incoming transmission is detected. Your radio will remain on that channel for 8 seconds after the last incoming transmission.

- During scanning (while receiving an incoming transmission), you can choose from the following:**
- Press and hold the **Talk** button to communicate on that channel. Your radio will remain on that channel and return to **Standby** mode.
  - Press the **Up** or **Down** button to resume scanning channels.
  - Press the **Talk** or **Call** button to return to Standby.

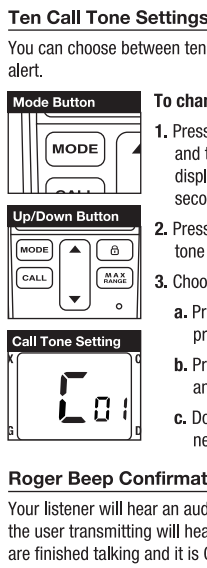

- Ten Call Tone Settings**
- You can choose between ten different **Call Tone Settings** to transmit a call alert.
- To change a call tone setting:**
- Press the **Mode** button repeatedly until the letter “C” and the current call tone number (01 through 10) is displayed. The current call tone will sound for three seconds.
  - Press the **Up** or **Down** button to hear the other call tone settings.
  - Choose one of the following:
    - Press the **Mode** button to enter the new setting and proceed to other functions.
    - Press **Talk** or **Call** button to save the new setting and return to **Standby** mode.
    - Do not press any buttons for 6 seconds to save the new setting and return to **Standby** mode.

- Roger Beep Confirmation Tone**
- Your listener will hear an audible tone when you release the **Talk** button and the user transmitting will hear this as well. This alerts the other party that you are finished talking and it is OK for them to speak.
- To turn roger beep on or off:**
- Press the **Mode** button repeatedly until the **Roger Beep** indicator flashes. The current **on** or **off** setting is displayed.
  - Press the **Up** or **Down** button to select **Roger Beep on** or **off**.
  - Choose one of the following:
    - Press the **Mode** button to enter the new setting and proceed to other functions.
    - Press **Talk** or **Call** button to save the new setting and return to **Standby** mode.
    - Do not press any buttons for 6 seconds to save the new setting and return to **Standby** mode.

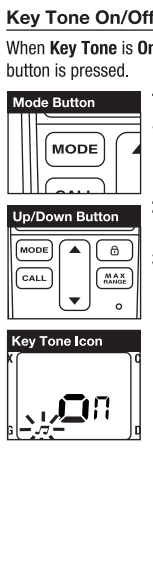

- Key Tone On/Off**
- When **Key Tone** is **On**, an audible tone will sound each time a front panel button is pressed.
- To turn key tone on or off:**
- Press the **Mode** button repeatedly until the **Key Tone** icon flashes. Current key tone status **on** or **off** will flash.
  - Press the **Up** or **Down** button to select key tone on or off.
  - Choose one of the following:
    - Press the **Mode** button to enter the new setting and return to **Standby** mode.
    - Press **Talk** or **Call** button to save the new setting and return to **Standby** mode.
    - Do not press any buttons for 6 seconds to save the new setting and return to **Standby** mode.

- Emergency Alert Mode**
- The Emergency Alert feature can be used to signal members in your group of your need for urgent help. RX380 series radios will operate in an automatic “hands-free” emergency control mode for a total of 30 seconds after activating the Emergency Alert. RX380 series radios in your group will automatically advance the speaker volume to the maximum setting and sound a warbling alert tone for 8 seconds. The alert tone is emitted from your own radio speaker and the receiving radios in your group. After the 8 seconds alert, any spoken words or incidental sounds at your end will be transmitted to the group for 22 seconds. For the 30 seconds duration of Emergency Alert mode, RX380 series radio controls and buttons will be locked to maximize reception of the emergency message.
- Press and hold the **Emergency Alert** button for 3 seconds.
  - Release the button after the LCD backlight flashes and the alert tone begins to sound. There is no need to continue to hold the **Emergency Alert** button or use PTT for your message to be transmitted.
  - After the alert tone ends you may speak into the microphone. Your voice or incidental sounds will be transmitted. The LCD backlight will continue to flash for the duration of the 22 seconds period.
  - After 30 seconds your radio speaker will emit a Talk Confirmation Tone and the LCD backlight will stop flashing. Operation then returns to normal two-way mode.

Note: All Cobra RX380 / RX680 / PX650 series radios are fully compatible with the Emergency Alert feature if they are on the same channel and same privacy code. Radio brands other than Cobra RX380 / RX680 / PX650 series can receive the emergency alert signal, but may not respond with adjusted volume settings, locked controls, or a warbling alert tone. Users of other radio models set to the same channel and code will hear a steady tone for 8 seconds followed by the voice transmission for 22 seconds.

**Warning:** The Emergency Alert feature should only be used in the event of an actual emergency. Cobra is not responsible if there is no response to the emergency alert from the receiving group.

## Operation

### General Specifications

Frequency Allocation and Compatibility	
Channel No.	Freq. in MHz
CH1	446.00625
CH2	446.01875
CH3	446.03125
CH4	446.04375
CH5	446.05625
CH6	446.06875
CH7	446.08125
CH8	446.09375
CH9	446.10625
CH10	446.11875
CH11	446.13125
CH12	446.14375
CH13	446.15625
CH14	446.16875
CH15	446.18125
CH16	446.19375

## Operation

### General Specifications

DCS Codes					
Cobra DCS	Octal Code	Cobra DCS	Octal Code	Cobra DCS	Octal Code
1	23	29	174	57	445
2	25	30	205	58	464
3	26	31	223	59	465
4	31	32	226	60	466
5	32	33	243	61	503
6	43	34	244	62	506
7	47	35	245	63	516
8	51	36	251	64	532
9	54	37	261	65	546
10	65	38	263	66	565
11	71	39	265	67	606
12	72	40	271	68	612
13	73	41	306	69	624
14	74	42	311	70	627
15	114	43	315	71	631
16	115	44	331	72	632
17	116	45	343	73	654
18	125	46	346	74	662
19	131	47	351	75	664
20	132	48	364	76	703
21	134	49	365	77	712
22	143	50	371	78	723
23	152	51	411	79	731
24	155	52	412	80	732
25	156	53	413	81	734
26	162	54	423	82	743
27	165	55	431	83	754
28	172	56	432		

## Warranty & Trademark Acknowledgment

**Trademark**

CEEL™ is a registered trademark of Cobra Electronics Europe, Ltd. Cobra and the snake design are proprietary trademarks of Cobra Electronics Corporation, USA. Other trademarks and trade names are those of their respective owners.

**Warranty & Customer Service**

For warranty and customer service information, please contact your dealer. For use in EU countries, subject to local laws and regulations.

**Disposal of Old Electrical or Electronic Equipment**

This product may contain hazardous substances that impact health and the environment if not disposed of properly.

The crossed out wheeled bin symbol indicates that the product should not be disposed along with household waste. It should be handed over to an applicable collection point for the recycling of electrical equipment. By ensuring that this product is disposed of correctly you will help/prevent potential negative impact on the environment.

If you need more information on the collection, reuse and recycling systems, please contact your local civic office or the shop where it was originally purchased.

©2024 Cobra Electronics Europe Ltd.  
www.eu.cobra.com



## Operation

### General Specifications

DCS Codes					
Cobra DCS	Octal Code	Cobra DCS	Octal Code	Cobra DCS	Octal Code
1	23	29	174	57	445
2	25	30	205	58	464
3	26	31	223	59	465
4	31	32	226	60	466
5	32	33	243	61	503
6	43	34	244	62	506
7	47	35	245	63	516
8	51	36	251	64	532
9	54	37	261	65	546
10	65	38	263	66	565
11	71	39	265	67	606
12	72	40	271	68	612
13	73	41	306	69	624
14	74	42	311	70	627
15	114	43	315	71	631
16	115	44	331	72	632
17	116	45	343	73	654
18	125	46	346	74	662
19	131	47	351	75	664
20	132	48	364	76	703
21	134	49	365	77	712
22	143	50	371	78	723
23	152	51	411	79	731
24	155	52	412	80	732
25	156	53	413	81	734
26	162	54	423	82	743
27	165	55	431	83	754
28	172	56	432		

**Trademark**

CEEL™ is a registered trademark of Cobra Electronics Europe, Ltd. Cobra and the snake design are proprietary trademarks of Cobra Electronics Corporation, USA. Other trademarks and trade names are those of their respective owners.

**Warranty & Customer Service**

For warranty and customer service information, please contact your dealer. For use in EU countries, subject to local laws and regulations.

**Disposal of Old Electrical or Electronic Equipment**

This product may contain hazardous substances that impact health and the environment if not disposed of properly.

The crossed out wheeled bin symbol indicates that the product should not be disposed along with household waste. It should be handed over to an applicable collection point for the recycling of electrical equipment. By ensuring that this product is disposed of correctly you will help/prevent potential negative impact on the environment.

If you need more information on the collection, reuse and recycling systems, please contact your local civic office or the shop where it was originally purchased.

©2024 Cobra Electronics Europe Ltd.  
www.eu.cobra.com

